

**SOLAR ROAD STUD**  
YOUR SAFETY EYES

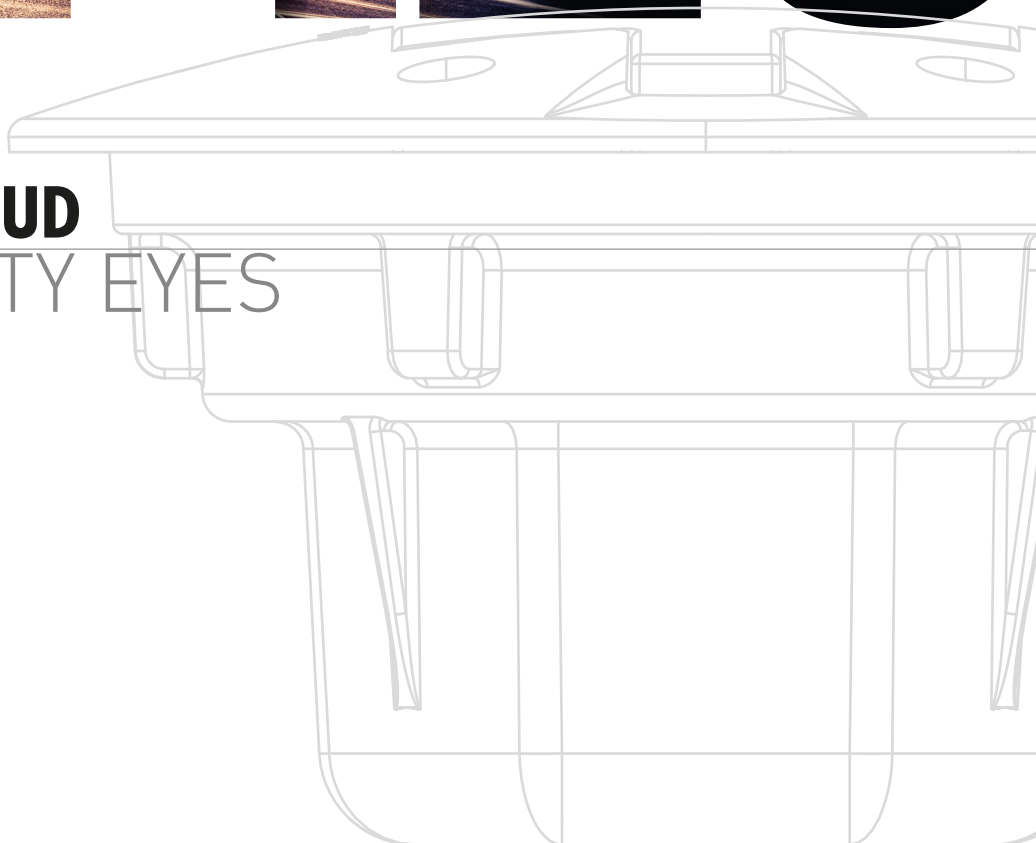

# SR-i20

## SOLAR ROAD STUD

### TECHNICAL FEATURES

- Use of microcontroller technology
- Appropriate for regular traffic zones and areas of poor visibility
- Ideal for road delineation, bends/curves, crosswalks among others applications
- Rising from road surface of 15mm
- SLEEP mode to prevent discharge during storage/transport
- Constant brightness during all functioning period
- Protection against deep discharge of the batteries/capacitors
- High performance photovoltaic solar module
- Energy storage in super capacitors or batteries
- Internal prismatic system
- Up to 1Km visibility distance due to high intensity LEDs
- Many led's color options for all kind of applications
- Easy maintenance
- Different CAP treatments available by request

### MODES OF OPERATION

Always On or Flashing

### LED'S CONFIGURATION

Unidirectional or Bidirectional

### ELECTRICAL FEATURES

**Power Supply:** Battery or Capacitor  
**Always On:** 1000h (Battery), 35h (Capacitor)  
**Flashing:** 2500h (Battery), 70h (Capacitor)  
**SLEEP mode autonomy:** 12 Months

### OPTICAL FEATURES

**LED's Quantity:** 1 or 2 LEDs (Unidirectional), 2 or 4 LEDs (Bidirectional)  
**LED's Type:** 5mm  
**LED's Color:** White, Warm White, Red, Amber, Green, Blue  
**Viewing Angle:** 15.°

### MECHANICAL FEATURES

**Dimensions:** Ø144 x 87 mm  
**Weight:** 1 Kg  
**Material:** Aluminum and Polycarbonate  
**Mechanical Resistance:** 20 Tons  
**Protection Index:** IP68 and IK10

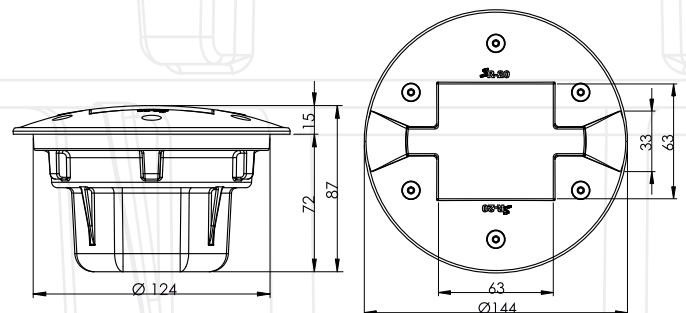

Dimensions: mm